

# GFV- 8

**RACING**<sup>®</sup>  
NO.GFV-8-01

## 閘刀式氣動切刀安裝手冊

## THE INSTRUCTION GUIDE BOOK FOR PNEUMATIC GUILLOTINE TAPE CUTTER

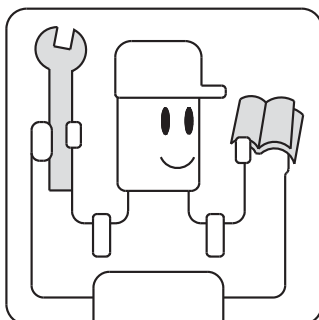

- 安裝本裝置必需具有專業的技師
- 安裝前，請詳細閱讀安裝說明書
- IT REQUIRES A SENIOR TECHNICIAN FOR INSTALLATION
- PLEASE READ INSTRUCTION & ASSOCIATED DRAWINGS BEFORE INSTALLATION

# 目錄

## INDEX

	頁數 Page
組合圖 / 安裝步驟 Combination / Setting	2~6
接線圖 / 管路圖 Wiring Diagram / Air Hose Plug Diagram	6
吸屑組 ( 選擇配件 ) / 保養 Suction Pipe Set ( Optional ) / Maintenance	7
直驅馬達 ( 賀欣牌 ) 編碼器接線圖 ( 選擇配件 ) Encoder Wiring Diagram for ( HoHsing ) D.D. Motor ( Optional )	8
零件圖 Parts List	9

# GFV-8 組合圖

## GFV-8 ASSEMBLY COMBINATION

**特別提醒!! 安裝本裝置必需具有專業的技師, GFV 閘刀式氣動切刀使用壽命是取決於您的安裝, 請務必參照本手冊步驟內容**  
**Notice & Reminder !! GFV must be installed by Experience Technician. The service life of GFV depends on the way of your installation. Please do follow each steps of installation manual.**

請依編號順序組合

Please assemble the device according to the indicated numbers.

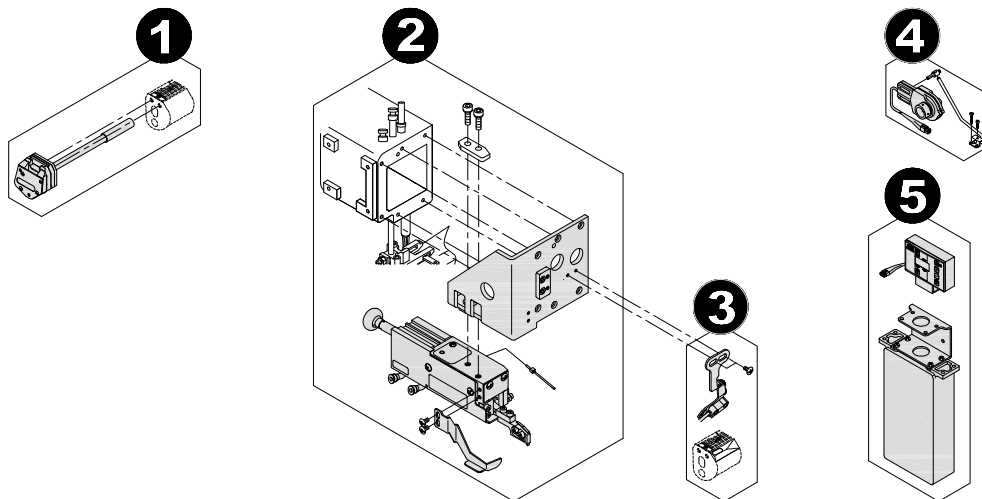

圖一  
Figure 1 上刀組各部位名稱與編號  
Parts Number and Description for Upper Blade set

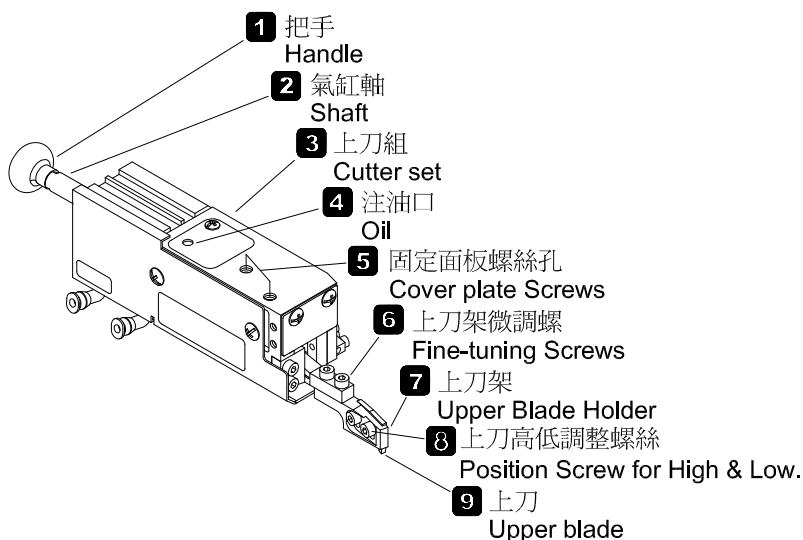

切刀動作圖  
Cutting Operation Fig

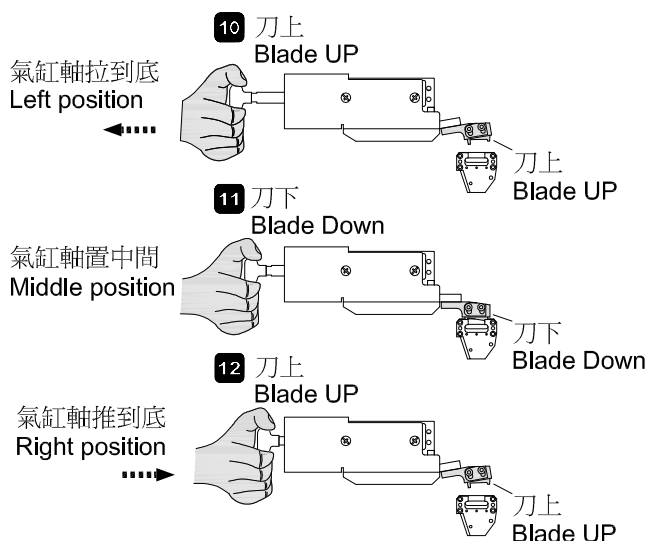

### 安裝步驟 SETTING

請依編號順序組合

Please assemble the device according to the indicated numbers.

1 圖二  
Figure 2

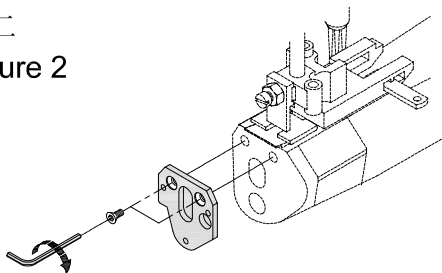

圖三  
Figure 3

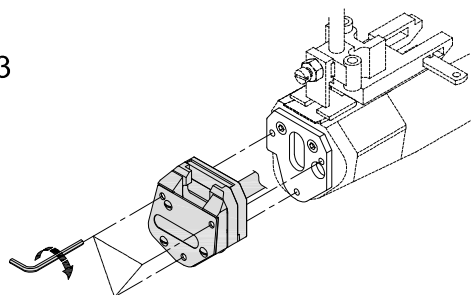

# 安裝步驟 SETTING

**2** 圖四  
Figure 4

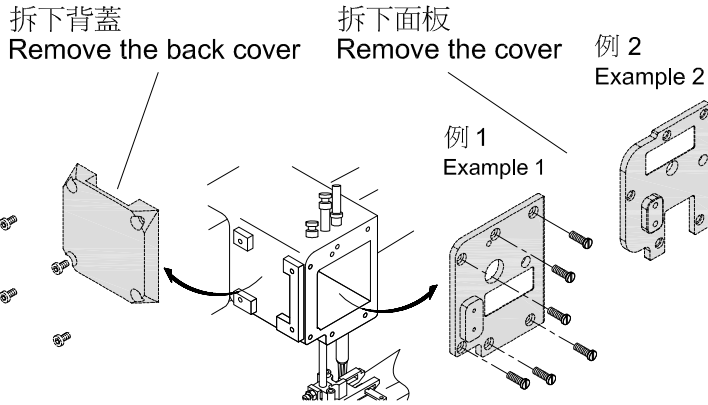

圖五  
Figure 5  
安裝專用面板  
Fixing the main bracket

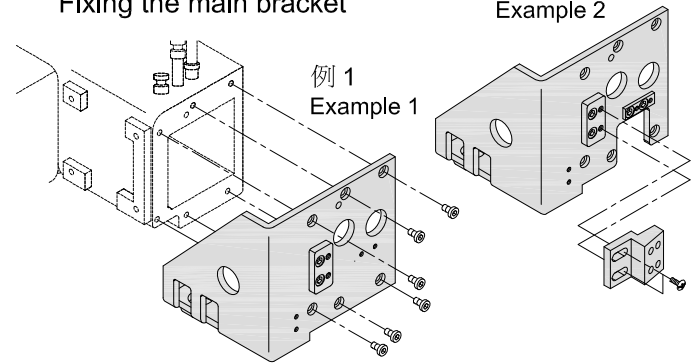

圖六 安裝上刀組  
Figure 6 Setting Upper Blade set

安裝前氣缸軸 **1** 拉到底 (刀上的位置 **10**)  
Pull the Handle 1 to the Left position (Blade Up 10)

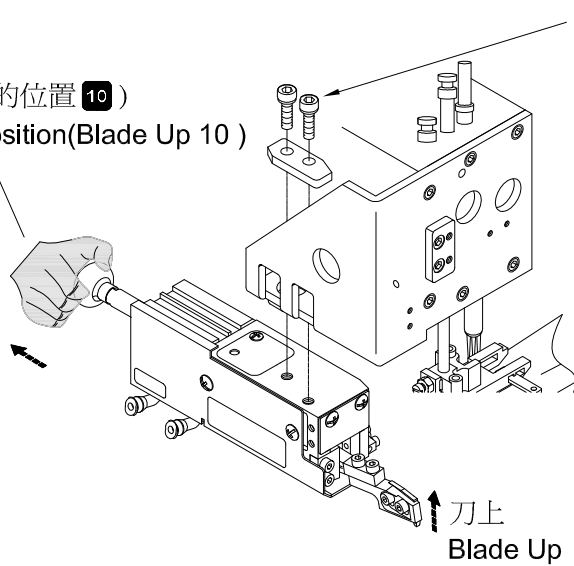

圖七  
Figure 7

**3** 此時螺絲固定上緊  
Lock the screws

置中間 **11**  
Middle position

**1** 氣缸軸置中間 **11** 上刀嵌入下刀座  
Upper Blade need to be place

**2** 上刀左右調整

上刀必需置於下刀座的中間,左右需有平均約0.7mm的空隙

The down position of Upper blade must in the middle. There is 0.7mm space for each side.

空隙0.7mm  
0.7mm space

空隙0.7mm  
0.7mm space

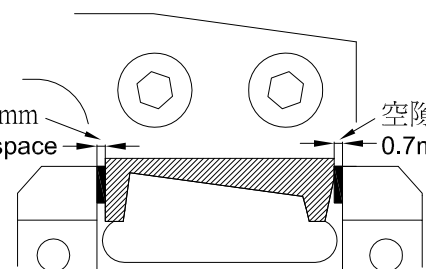

# 安裝步驟 SETTING

圖八  
Figure 8 ④ 上刀高低調整

## Setting High & Low for Upper Blade

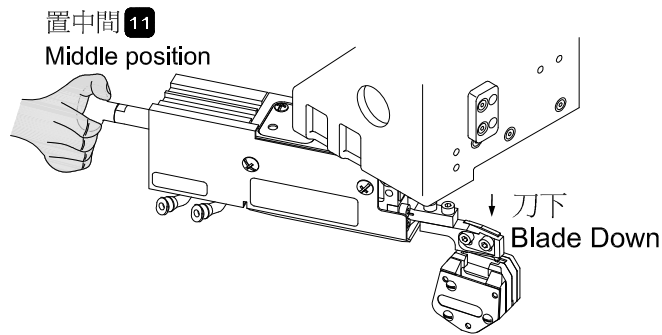

在刀下的位置 (如下圖) 調整上刀與下刀需重疊1mm  
The Upper Blade need to overlap 1mm with Lower Blade when setting as following Figure.

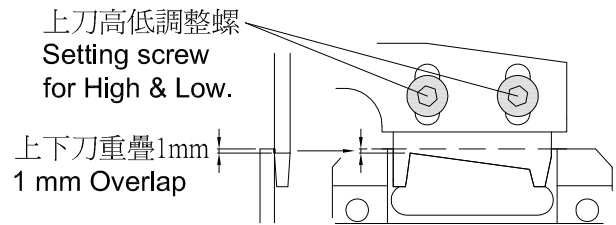

圖九  
Figure 9 ⑤ 上刀架微調

## Fine setting for Upper Blade

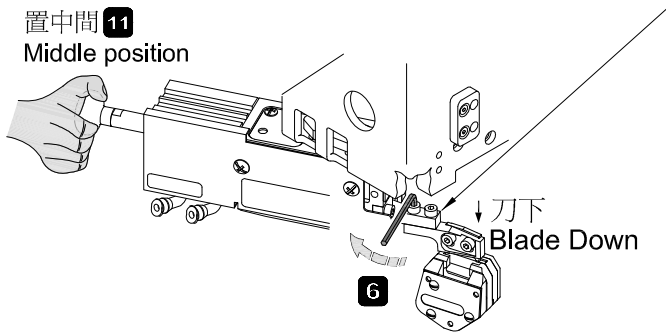

上刀架 ⑨ 微調  
Fine setting for Upper Blade

上刀在刀下的位置放鬆微調螺絲 ⑥ 輕輕前後搖動上刀架 ⑦ 使上刀與下刀接觸吻合 (如下圖) 後上緊微調螺絲 ⑥  
Please move the Upper Blade Holder 7 forward and backward to make sure the blades contact is gentle smoothly (Refer the following Figure) then lock the fine setting screws 6.

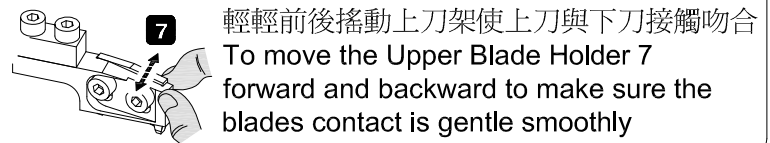

圖十 測試  
Figure 10 Test

- ⑥ 1: 測試上、下刀動作是否平順,切線銳利  
上、下刀微調固定後,必須拉動把手 ① 測試上刀擺動是否平順,及測試切刀是否鋒利(如下圖)  
2: 若上刀擺動不平順(太緊)時上、下刀容易磨損影響使用壽命  
3: 若無法切斷線頭時表示上下刀接觸不良

上述兩種情況必須重新再放鬆上刀架微調螺絲,再微調上刀組 (如圖九),直到上刀組拉動平順,線頭切斷為止,方可以開始使用

1: To test both blades act cutting smoothly and sharply.

After setting the Fin setting for both blades, please pull the Handle 1 manually to act the cutter to make sure it is smoothly and with sharp cutting (Refer to the following Figure)

- 2: It will shorten the life of Lower Blade if the cutter is not smooth or too tie.  
3: If there is problem to cut the thread chain, the blades contact is not correct  
Please re-setting the position again by refer to Figure 9 until cutting smoothly and sharply

測試動作平順 Test for cutting smoothly

測試切線銳利  
Test for cutting sharply

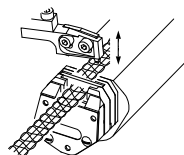
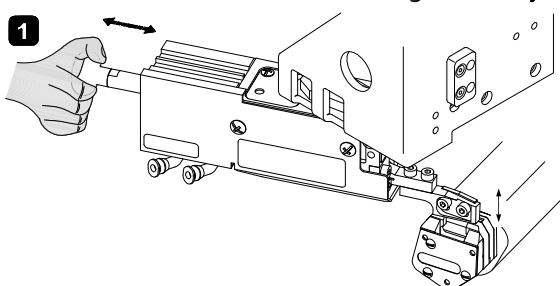

圖十一 安裝保護蓋  
Figure 11 Setting the Safety Cover

調整空隙要小於指頭免受傷害  
The space should be small than finger

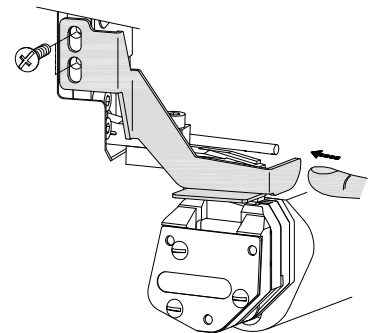

安裝步驟  
SETTING

圖十二 安裝吹氣管  
Figure 12 Setting the Ejection Air pipe

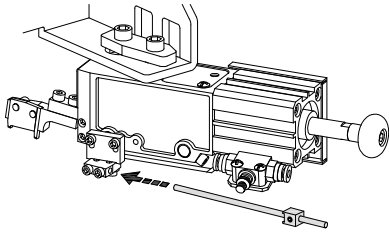

圖十三 連接原有吸屑管  
Figure 13 Plug with Vacuum Air Hose

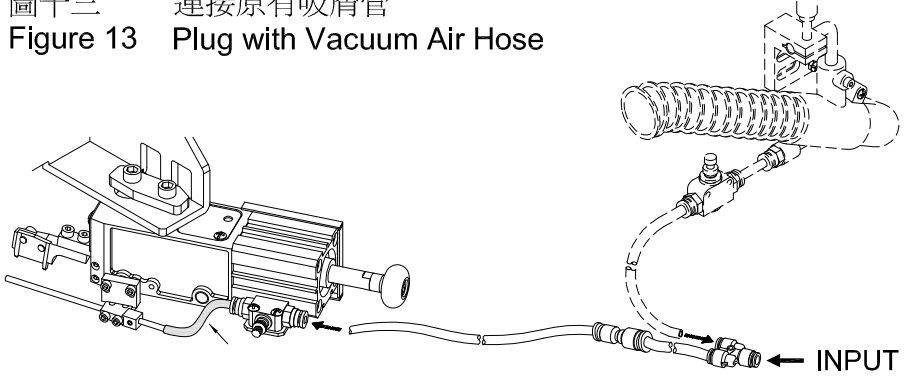

圖十四 吹氣的角度約45°  
Figure 14 Air Ejection Angle about 45

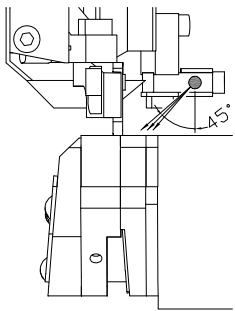

圖十五 調整吹氣管及吹氣量  
Figure 15 Setting Air Hose and Air Ejection

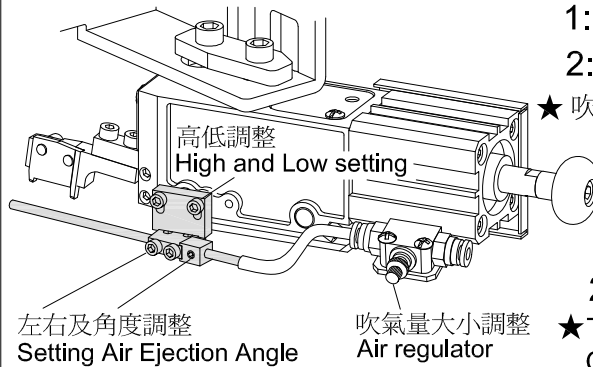

調整適中的吹氣量

★ 吹氣量太小影響:

- 1: 車縫布料容易阻塞在壓布腳與切刀之間
- 2: 線頭容易偏離切刀

★ 吹氣量太大: 影響吸布屑管的順暢

Please setting the proper Air Ejection

★ The influence of lacking Air Ejection

- 1: Causing Fabric jammed between pressure foot and blade.
- 2: Thread Chain will out from the blade.

★ The influence of excessive Air Ejection: Causing problem for Suction pipe set

3 圖十六 安裝光電組  
Figure 16 Fix Photo sensor

貼上反光板  
Stick the Reflex plate

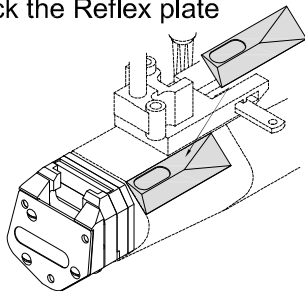

圖十七 光電感測組固定  
Figure 17 Setting the Photo-sensor set

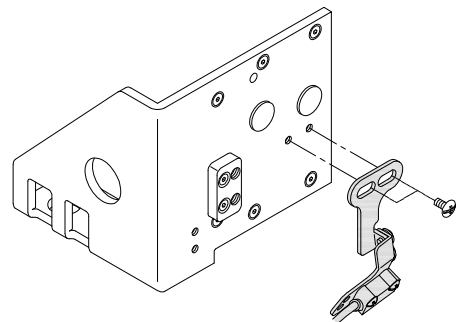

圖十八  
Figure 18

左右調整  
Setting Right and Left

角度調整  
Setting the Angle

感測器  
Photo-sensor

反光板  
Photo-sensor

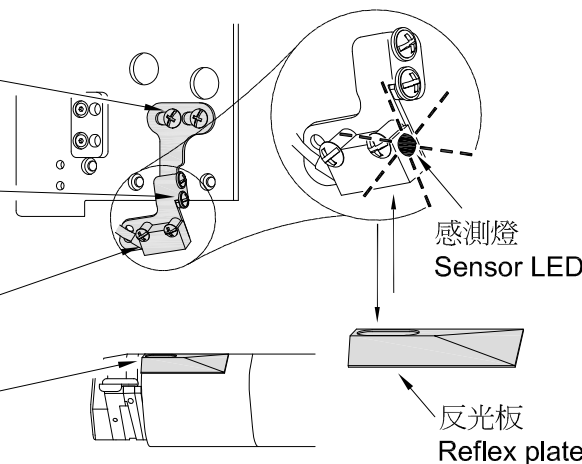

切刀光電組調整:

感測器對準反光板,感測燈必須是亮橙色的,如感測燈亮藍色或閃爍表示位置不準確,必需調整感測器的角度。

Setting the Photo-sensor :

Sensor Orange LED must be light up when sensor aims at reflex plate. If the sensor Orange LED is either sparkly or light off, please adjust the position or angle and of Photo sensor

# 安裝步驟 SETTING

## 4 安裝檢知器 Install SY-Synchronizer

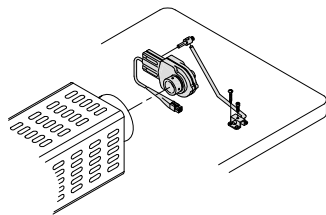

## 5 安裝控制組 Install the Control Box

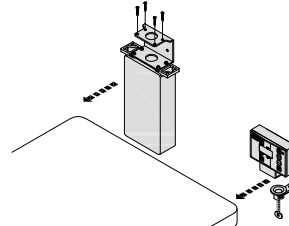

# 管路圖 AIR HOSE PLUG

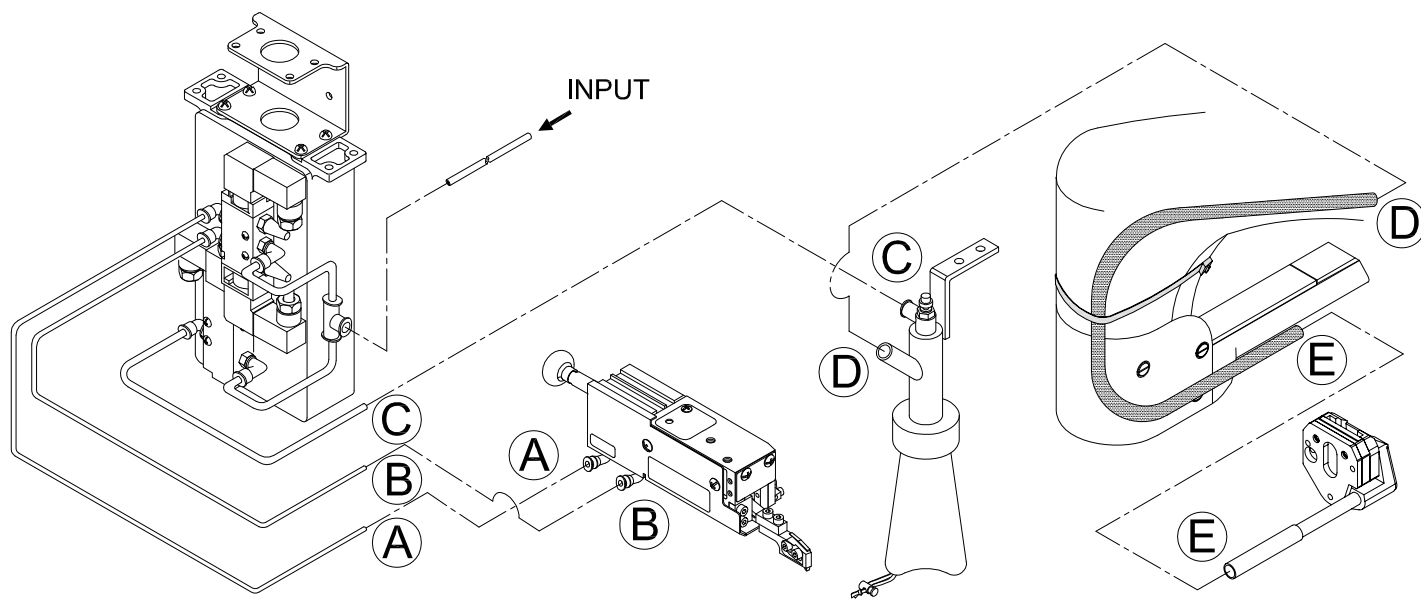

# 接線圖 WIRING DIAGRAM

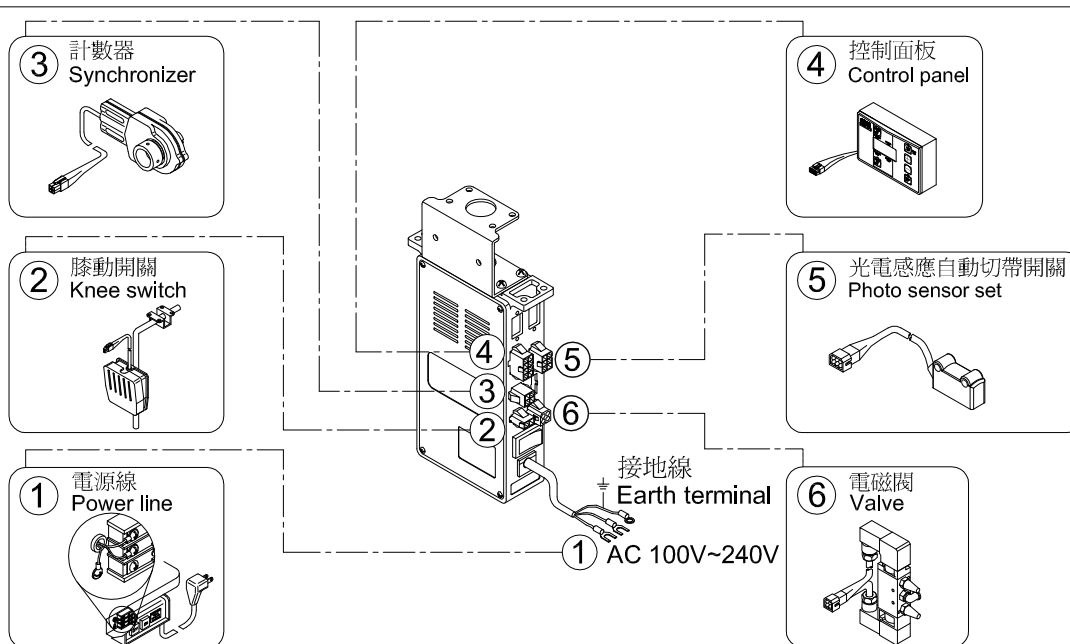

## 保養 MAINTENANCE

每週加油一次

Please oil at the least once a week.

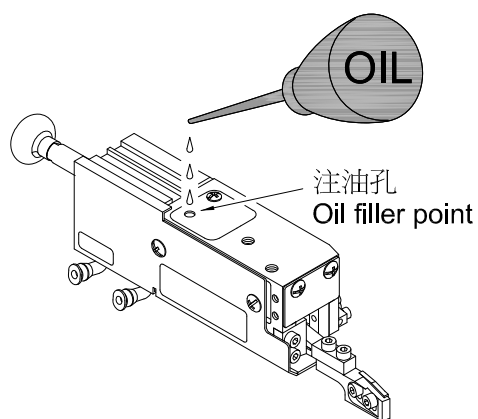

吸屑組 ( 選擇配件 )

SUCTION PIPE SET ( OPTIONAL )

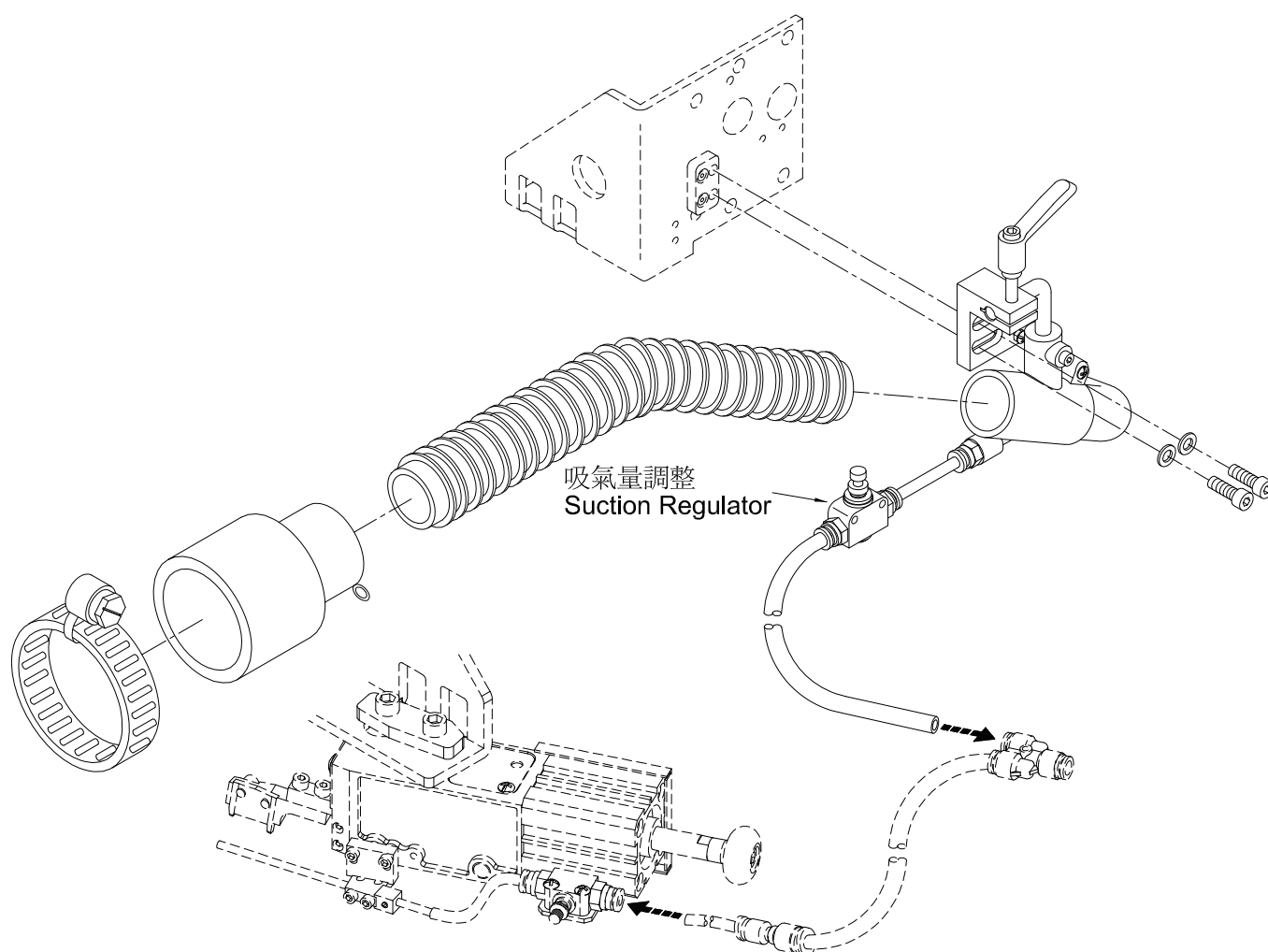



## 直驅馬達 ( 賀欣牌 ) 編碼器接線圖 ( 選擇配件 )

## ENCODER WIRING DIAGRAM FOR ( HOHSING ) D.D. MOTOR ( OPTIONAL )

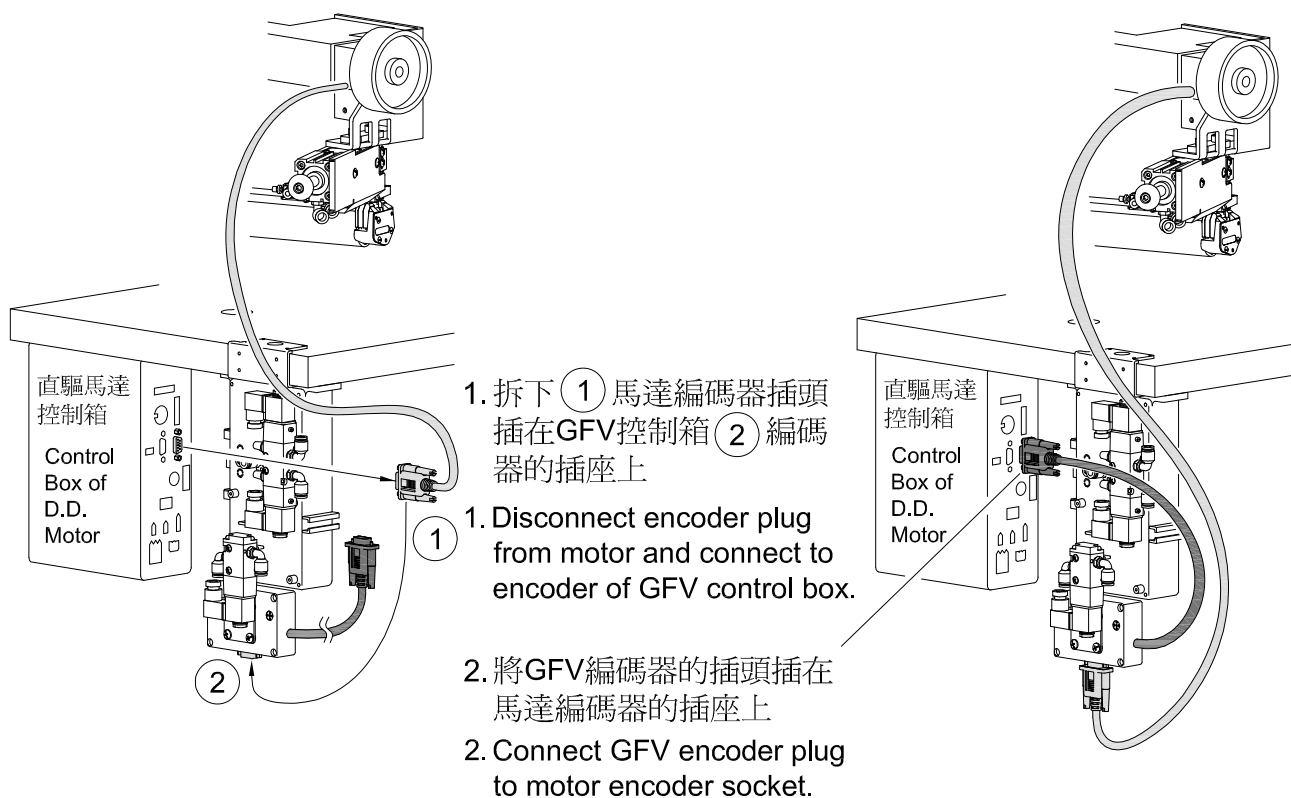
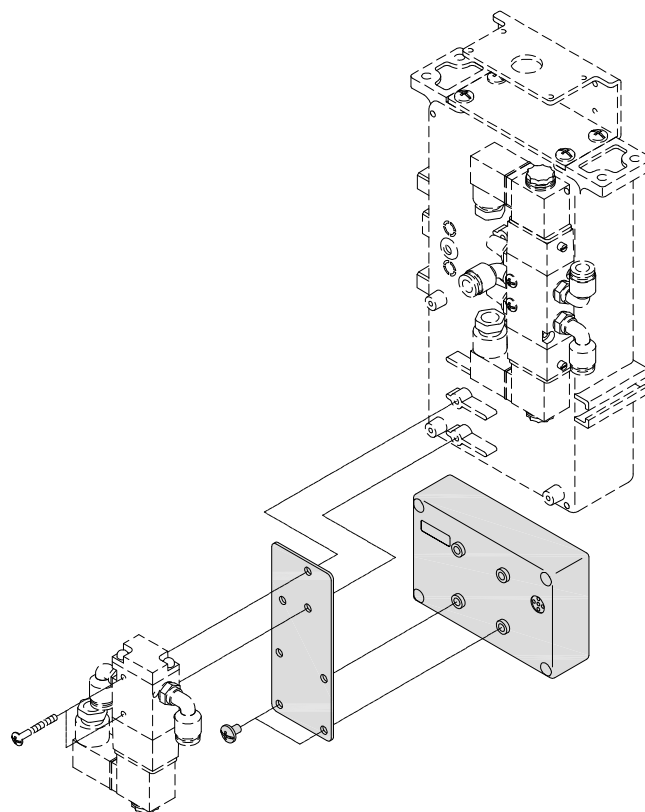

# GFV-8 零件圖

## GFV-8 PARTS LIST

記號說明：  
Mark description

- ? 選擇性配件,請告知直驅馬達廠牌機型
- Please indicate direct drive motor model No. for optional parts.

